

CONFIDENTIAL

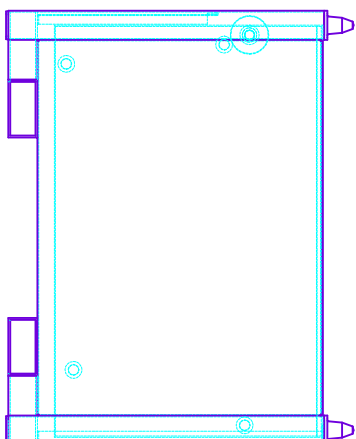
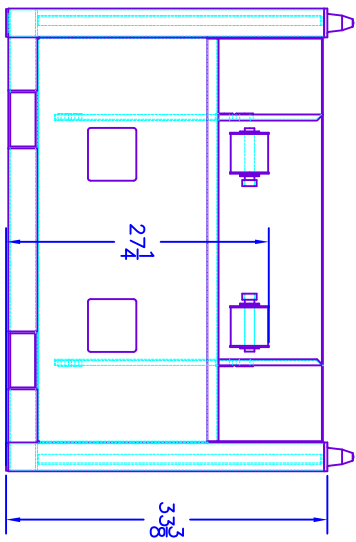
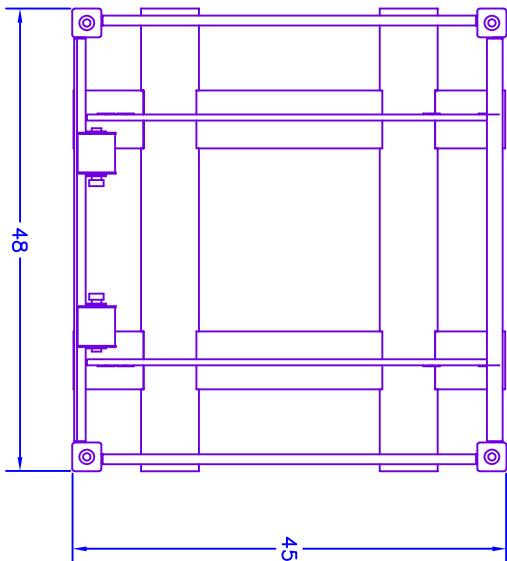

Weight Capacity: 4,000 lbs max
Bar Length Range: 24" to 40"
Bar Quantity: 4,000 pcs
Stackable up to 4 high

[HTTP://WWW.ABSOLUTEENGINEERING.COM](http://www.AbsoluteEngineering.com)

ATTENTION: ANY INFORMATION CONTAINED IN

THIS DOCUMENT IS PROPRIETARY AND IS TO BE
CONSIDERED CONFIDENTIAL PROPERTY OF
ABSOLUTE ENGINEERING COMPANY. THIS
DOCUMENT IS NOT TO BE REPRODUCED OR
DISTRIBUTED WITHOUT WRITTEN PERMISSION
FROM ABSOLUTE ENGINEERING COMPANY.

REV.

**ABSOLUTE
ENGINEERING
COMPANY**

Self-unloading Hopper

(419) 535-9715

FAX: (419) 535-9717

**715 N. WESTWOOD AVE.
TOLEDO, OHIO 43607**

SIZE

A

JOB NO.

PO-0000

DWG NO.

SelfUnloadingHopper.PDF

REV

2

SCALE

DO NOT
SCALE

03/01/2007

SHEET

1

of

1